

Date	Rev. date	Work nr.	Drw. nr.	Rev.
Drawn by Ruukki	Rev.	M35/S23-b	-	
Scale 1:3	Building	File nr. P2021/001-00036		

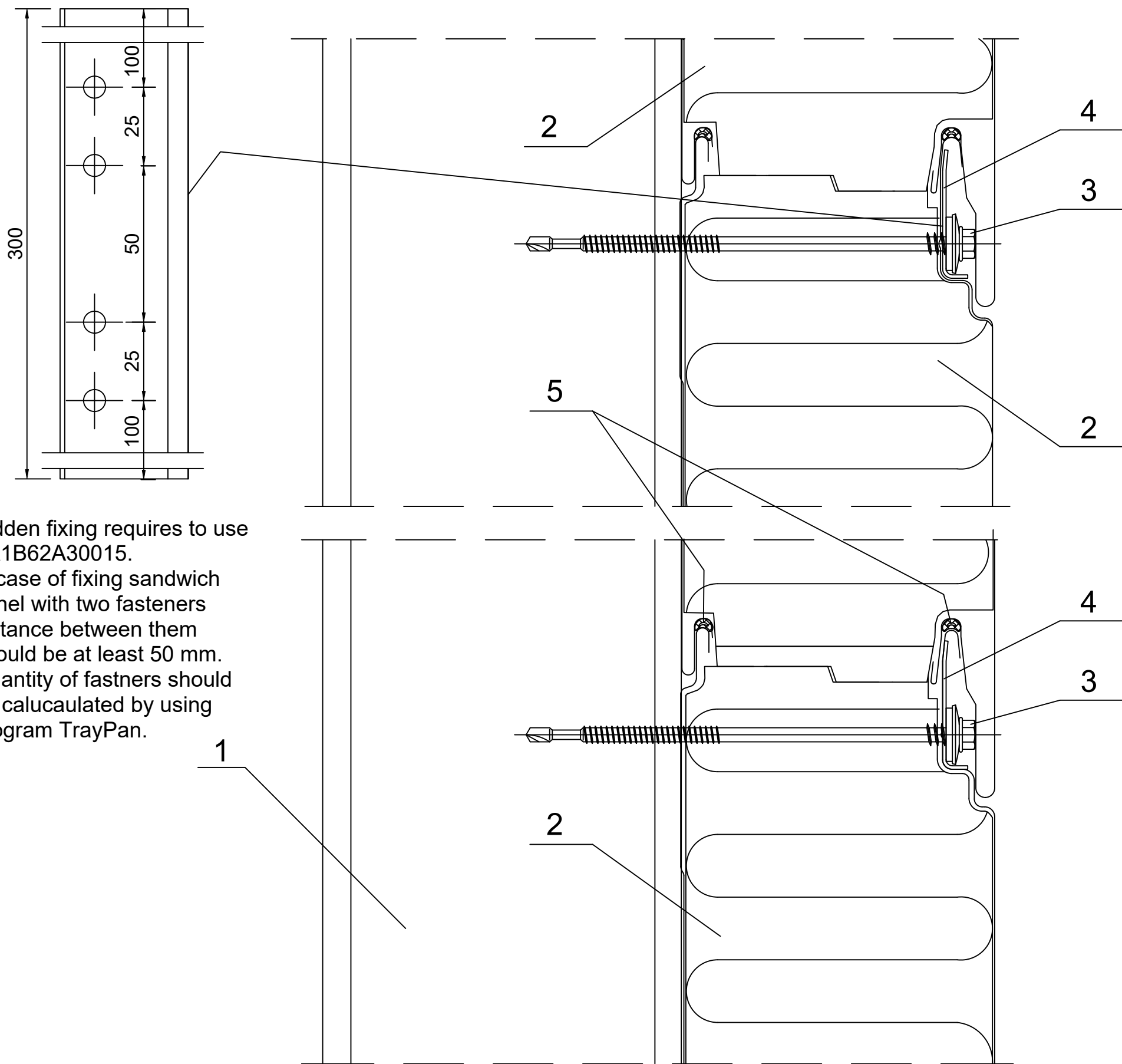

Hidden fixing requires to use  
EA1B62A30015.  
In case of fixing sandwich  
panel with two fasteners  
distance between them  
should be at least 50 mm.  
Quantity of fastners should  
be calucaulated by using  
program TrayPan.

- 1. Steel column acc. to engineering design of the structure.
- 2. Ruukki nSPD WE.
- 3. Panel fastener for hot-rolled steel column or for cold-bentsteel column.
- 4. EA1B62A30015 fastener.
- 5. Butyl sealing compound (to be installed on side) or EPDM gasket (installed during production)

NOTES:  
The insulating core of properly installed panels fits tightly to each other.